



# Quick Reference Card

Please consult your spa user manual for complete info on the features of your spa system.



## in.k600

Advanced series of full-function keypads that give complete control to wet fingers!

Aeware's new series of keypads features a high profile with a large LCD display, menu-driven interface and raised keys that let users easily control all in.xm functions and programming directly from spa side, creating a true and unique user experience.

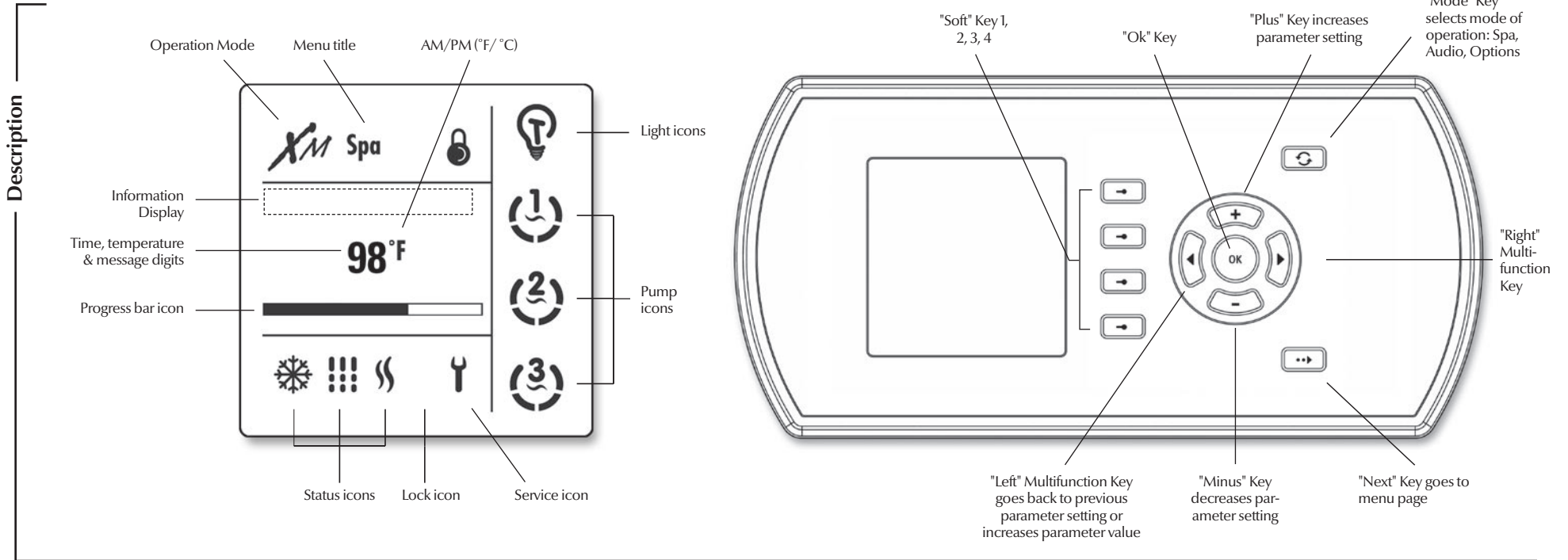

### Main Functions

- Setting Temperature
- Start Pump 1
- Start Pump 2
- Start Pump 3
- Start Light
- Starting Blower
- Economy Mode
- Standby Mode
- Display Time
- Progress Bars

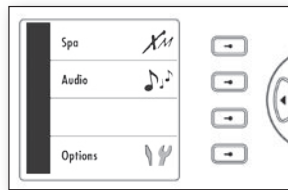

This menu allows control of all pumps, blower and spa light, as well as the activation of the Economy and Standby modes. Every time a device is on, its animated icon is displayed. All pump activity can be stopped at once by activating the Standby mode.

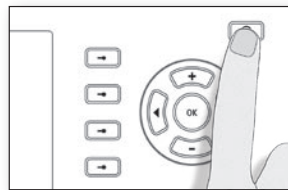

- Press **Mode** key to display the mode Selection window.



- Select **Spa** to view Spa menu.

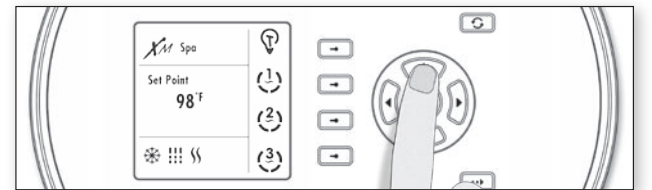

#### Water temperature setting

- Press **Plus/Minus** key to select water temperature setting.
- Press **OK** key or wait 5 seconds to confirm new setting. The "Set Point" prompt indicates the desired temperature NOT the current water temperature.

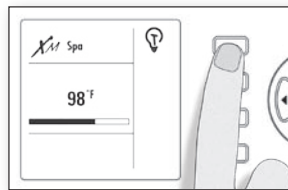

#### Starting Light

- Select **Light** key to turn light on.
- Select **Light** key repeatedly to control light intensity. A final selection turns light off.

(120 minute built-in timer)

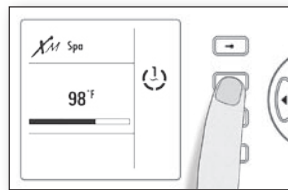

#### Starting Pump 1

- Select **Pump 1** to turn Pump 1 on.
- Select **Pump 1** repeatedly to control pump 1 speeds.

(20 minute built-in timer)

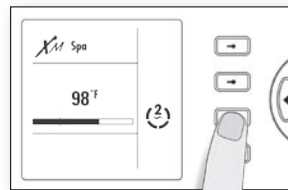

#### Starting Pump 2\*

- Select **Pump 2** to turn Pump 2 on.
- Select **Pump 2** repeatedly to control pump 2 speeds.

(20 minute built-in timer)

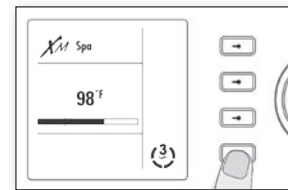

#### Starting Pump 3\*

- Select **Pump 3** to turn Pump 3 on.
- Select **Pump 3** once more to turn pump 3 off.

(20 minute built-in timer)

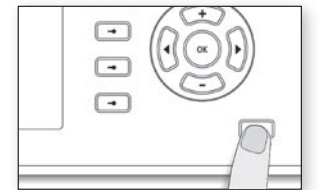

#### Next menu page

- Press **Next** key to display the next page in the spa menu.

Goes to blower option



#### Starting Blower\*

- Select **Blower** to turn Blower on.
- Select **Blower** once more to turn blower off.

(20 minute built-in timer)

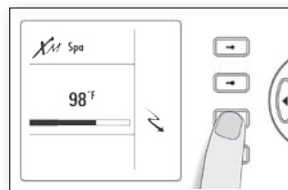

#### Turning Economy on

Lowers the temperature set point of the spa by 20°F (11°C).

- Select **Economy** to activate the Economy mode.
- Select **Economy** again to override economy programming (see spa setup section).

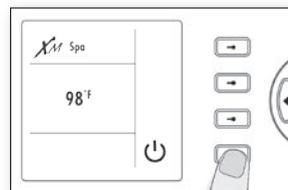

#### Standby Mode

Stops all pumps at the same time by a simple click of a button!

- Select **Standby** to activate this mode.
- Select **Standby** to again to resume normal operations.

System automatically returns to Normal mode after a certain period of time, unless the Standby mode has been reactivated. Spa light will flash for a few seconds before the exit of Standby mode and restart the pumps. The "Standby" message is also displayed during Standby mode.

\* Pump will stay turned on if there is a request for more heat.

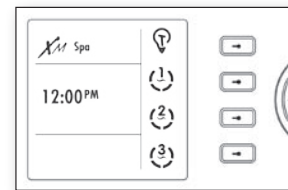

#### Displaying time

- Press **Ok** key to display the time.
- Press **Ok** key a second time to go back to water temperature display.

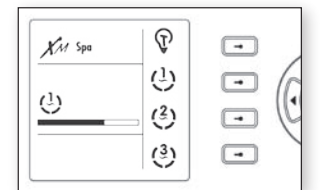

#### Viewing active progress bars

A progress bar is a visual indicator of the time remaining before a device is turned off. Only one bar is displayed at the time.

- Use **Left** or **Right** keys to visualize the progress bar of each activated device.

\*option available depending upon factory settings

## Programming

- Filter cycles
- Economy Mode
- Reminders
- Warnings

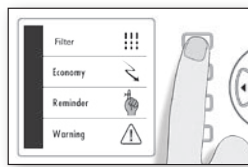

### Programming spa system

To program the filter cycle, you must enter these parameters: start time, duration and frequency. During a filter cycle, pumps run for one minute to purge the plumbing, then Pump 1 runs for the programmed number of hours.

- Press **Mode** key
- Select **Options** menu
- Select **Spa** sub-menu
- Select **Filter** option

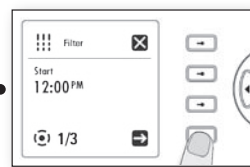

### Setting filter cycles start time

The display will show the starting hour previously set.

- Use (+) or (-) key to select hour setting.
- Use **Right** key to set minutes.
- Use (+) or (-) key to change minutes.
- Select **Next arrow** on screen menu to go to the next parameter: filter cycle duration.

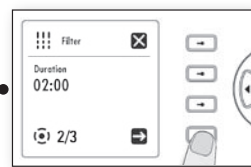

### Setting cycle duration

Here we set a value for the filter cycle duration, in hours and minutes.

- Use (+) or (-) key to set hour setting.
- Use **Right** key to set minutes.
- Use (+) or (-) key to change minutes.
- Select **Next arrow** on screen menu to save changes and go to the next parameter: filter cycle frequency.

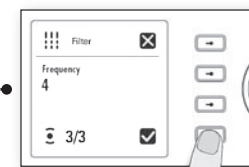

### Setting filter cycle frequency

Here we set the number of filtering cycles that the system will perform per day.

- Use (+) or (-) key to select frequency setting.
- Select **Enter** option on screen menu to save changes and go to back to spa options main menu.

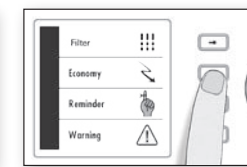

### Setting Economy mode\*

- Select **Economy**



### Setting Economy status

- Use (+) key to enable the economy mode, the display will show **On**.
- Use (-) key to disable economy mode, the display will show **Off**.



### Setting Economy start time

- Select **Next arrow** on screen menu to save changes and go to economy cycle start hour.
- Use (+) or (-) key to set hour setting.
- Use **Left** key to access minutes option.
- Use (+) or (-) key to set minutes.
- Select **Next arrow** on screen menu to save changes and go to the next parameter stop economy.



### Setting Economy stop time

- Use (+) or (-) key to set hour setting.
- Use **Left** key to access minutes option.
- Use (+) or (-) key to set minutes.
- Select **Enter** option on screen menu to save changes and go to back to spa options menu.



### Setting maintenance reminder prompts

This menu allows you to activate/deactivate or simply reset the maintenance reminder prompts.

- Select **Reminder** option

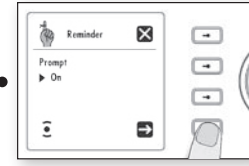

### Turning reminders on/off\*

- Use (+) or (-) key to activate or deactivate prompt(s).
- Select **Next arrow** on screen menu to save changes and go to next menu screen.

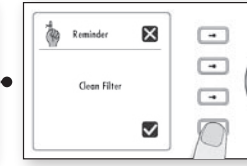

### Resetting prompt messages

- Use **Left** or **Right** keys to review one by one all active maintenance messages.
- Select **Enter** option on screen menu to reset message and view next task or go back to main menu.

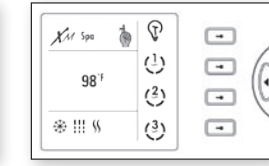

### Viewing spa reminders

The reminder icon will show up to prompt you to review active maintenance messages.

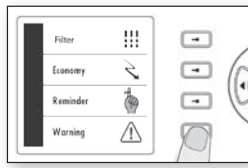

### Spa warnings

This menu allows for you to view all active warning messages ie.: hot water.

- Select **Warning** option



### Turning warnings on/off

- Use **Left** or **Right** keys to review all warning messages.
- Press **Mode** key again to go back to main menu.



### Viewing spa warnings

The warning icon shows up to prompt you to review active warning messages.

## Time setting

- Time of day

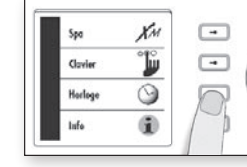

### Setting the time

- Press **Mode** key
- Select **Options** menu
- Select **Clock** setting

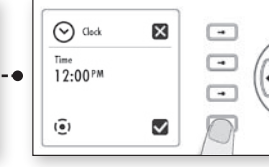

### Setting hour settings

- Use (+) or (-) key to set hour setting.
- Use **Left** or **Right** keys to access minutes option.
- Use (+) or (-) key to set minutes.
- Select **Enter** option on screen menu to back to keypad main menu.

## Other Settings

- Keypad display
- Sound
- Regional
- Security



### To program keypad settings

- Press **Mode** key
- Select **Options** menu
- Select **Keypad** sub-menu



### Setting keypad display options

This sub-menu is used to set keypad display settings such as: contrast, backlight, etc.

- Select **Display** options



### Adjusting contrast

- Use **Left** or **Right** keys to adjust desired level of contrast.
- Select **Next arrow** on display to save changes and go to next screen menu.

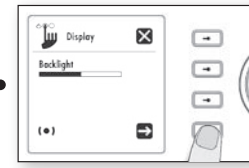

### Adjusting backlight

- Use **Left** or **Right** keys to adjust backlight brightness.
- Select **Next arrow** on display to save changes and go to next screen menu.

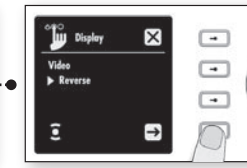

### Normal/Reverse display

- Use (+) or (-) key to activate or deactivate reverse display.
- Select **Next arrow** on display to save changes and go to next screen menu.



### Display orientation (inverting)

- Use (+) or (-) key to activate or deactivate reverse display.
- Select **Enter** option on screen menu to back to keypad main menu.

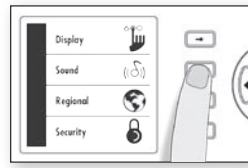

### Setting keypad audio options

This sub-menu is used to set keypad audible options setting such as: keypad on (key beep) and alarm.

- Select **Sound** options



### Keypad beep on/off

- Use (+) or (-) key to activate or deactivate reverse display.
- Select **Next arrow** on display to save changes and go to next screen menu.



### Turning alarm sound on

- Use (+) or (-) key to activate or deactivate alarm sound.
- Select **Enter** option on screen menu to save changes and go back to main menu.



### Setting regional settings

This sub-menu is used to set keypad regional settings such as: language, select temperature display units and choose a format for time display.

- Select **Regional** options



### Setting language

- Use (+) or (-) to select from: English, Français Spanish & Deutsch
- Select **Next arrow** on display to save changes and go to next screen menu.

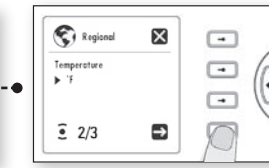

### Temperature units

Water temperature can be displayed in °F or °C.

- Use (+) or (-) to change setting.
- Select **Next arrow** on display to save changes and go to next screen menu.



### Selecting time format

- Use (+) or (-) to change setting.
- Select **Enter** option on screen menu to save changes and go back to keypad main menu.



### Security options

Partial keypad lock: basic functions of the spa remain accessible (pump and light outputs) but it's impossible to change the temperature Set Point, or to enter Programming mode. Full lock: all keys are disabled. When the keypad is locked, the icon will be displayed.

- Select **Security** options



### Partial keypad lockout

- Use (+) or (-) key to select "Partial".
- Select **Enter** option on screen menu to back to keypad main menu.

To unlock the keypad:

- Select **Mode** key
- Press and hold **Option** key for 5 seconds



### Full keypad lockout

- Use (+) or (-) key to select "Full".
- Select **Enter** option on screen menu to back to keypad main menu.

To unlock the keypad, press and hold **Light** key for 5 seconds.

## System info

- Spa
- Heater
- Keypad
- Reset
- Upgrade

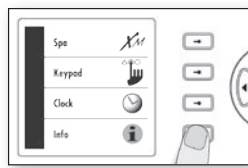

### Viewing information about the system

To view spa equipment data such as: system, heater and keypad software version, to reset programmed settings and to upgrade keypad software.

- Press **Mode** key
- Select **Options** menu
- Select **Info** sub-menu



### Viewing information about spa

Spa software ID number and version are displayed.

- Select **Next arrow** on display to next screen menu.



### Viewing information on heater software

Heater software ID number and version are displayed.

- Select **Next arrow** on display to next screen menu.

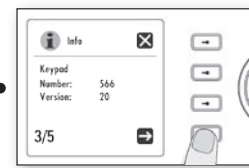

### Viewing information on keypad software

Keypad software ID number and version are displayed.

- Select **Next arrow** on display to next screen menu.

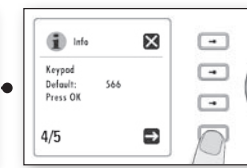

### Resetting keypad programmed values

- Press **Ok** to reset back to default factory values.
- Select **Next arrow** on display to next screen menu.

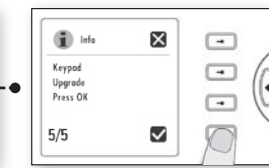

### Upgrading keypad software

- Use **Ok** key to start the upgrade of the software of the keypad.
- Select **Enter** option on screen menu to back to keypad main menu and not upgrade the software of the keypad.

\*option available depending upon factory settings